

E-Stop Switch with IP65 Rating & Wire Leads

Series FF01

FF0116BACEEA01-WL

Dimensions in mm/inch

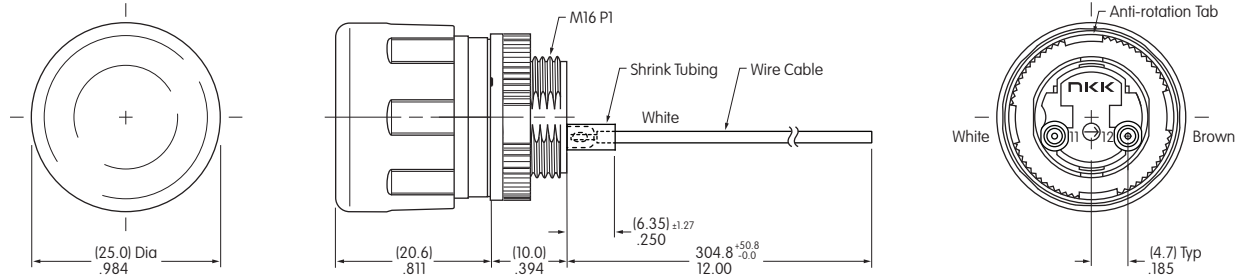

SINGLE POLE SOLDER LUG

Base Switch	Pole & Throw	Plunger Position		Connected Terminals		Throw & Switch Schematics
		Normal	Down	Normal	Down	
						Note: Terminal numbers are on the switch.
FF0116BACEEA01	SPST	ON	OFF	11-12	OPEN	SPST NC

PANEL CUTOUT

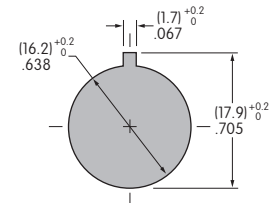

Recommended Panel Thickness:
.031" ~ .177" (0.8mm ~ 4.5mm)

WIRING

Number of Wires	Terminal 11	Terminal 12
2	White	Brown

WIRE SPECIFICATIONS

UL1007/UL1569 PVC	Temperature: +80°C and +105°C (+176°F and +221°F)
Voltage: 300V	
22 AWG Stranded	Stripped Wire Ends .142" (3.6mm)

Base Switch Specifications

Electrical Capacity

Resistive Load: 0.5A @ 24V DC

Other Ratings

Rated Insulation Voltage:	36V DC
Impulse Withstand Voltage:	2.5kV
Contact Resistance:	50 milliohms maximum
Insulation Resistance:	100 megohms minimum @ 500V DC
Mechanical Life:	100,000 operations minimum
Electrical Life:	100,000 operations minimum
Operating Force:	Push to lock 10.8N; Pull to reset 8.5N; Turn to reset 0.13N·m
Minimum Direct Operating Force:	15N
Short Circuit Protection:	gG10A
Conditional Short Circuit Current:	1000A
Minimum Positive Opening Travel:	.118" (3.0mm)
Total Travel:	.177" (4.5mm)
Operation Frequency:	10 times per minute
Overvoltage Category:	II

Materials & Finishes

Actuator:	Glass fiber reinforced polyester (PBT)
Housing:	Glass fiber reinforced polyamide
Movable Contacts:	Silver alloy copper with gold plating
Stationary Contacts:	Silver alloy copper with gold plating
Terminals:	Brass with tin plating

Environmental Data

Operating Temperature Range:	-25°C ~ +60°C (-13°F ~ +140°F)
Storage Temperature Range:	-45°C ~ +80°C (-49°F ~ +176°F)
Humidity:	90 ~ 95% humidity for 240 hours @ +40°C (+104°F)
Vibration:	10 ~ 500Hz, amplitude 0.35mm. Acceleration 50m/s ²
Shock:	Durability: 1,000m/s ² ; Malfunction: 150m/s ²
Pollution Degree:	3
Sealing:	Meets IP65 of IEC 60529 Standards at front panel

Installation

Mounting Torque:	785mN·m
Soldering Time & Temperature:	Manual Soldering: 390°C max for 4 seconds max, 2 cycles
RoHS Compliant:	

Standards & Certifications



UL, C-UL (UL508)



EN 60947-5-1, EN 60947-5-5



Emergency Stop Switches



Characteristics

Low profile body and impressively short behind panel depth of only 13.6mm offer advantages to high density panel layouts. Switches are IP65 rated at the front panel per IEC 60529 Standards (dust tight and protected against water jets from any direction). Outstanding safety and reliability factors are benefits of unique sliding latch mechanism that maintains the OFF state of the contacts. Protection against rugged vibration and chattering credited to internal construction featuring superior shock resistant properties.

All models have solder lug terminals and an actuator in 25 or 30mm diameters, with directional arrow legend or blank surface. Resetting methods include both twisting or pull release for enhanced safety.

The FF01 Series has various accessories, including a protective guard and nameplates with *EMERGENCY STOP* legend or blank. The nameplates and switch guard are all interchangeable for both actuator sizes.

Optional Accessories

AT221 Nameplate without Legend

One o-ring is provided with each nameplate

Materials & Colors:

Nameplate: Glass fiber reinforced polyamide

O-ring: Chloroprene rubber

Nameplate: Yellow

O-ring: Black

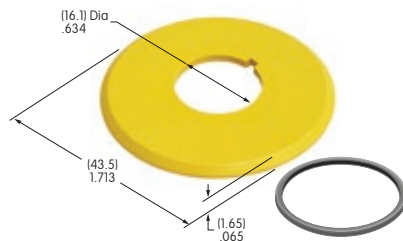

AT222 Nameplate with Emergency Stop Legend

One o-ring is provided with each nameplate

Materials & Colors:

Nameplate: Glass fiber reinforced polyamide

O-ring: Chloroprene rubber

Nameplate: Yellow with black letters

O-ring: Black

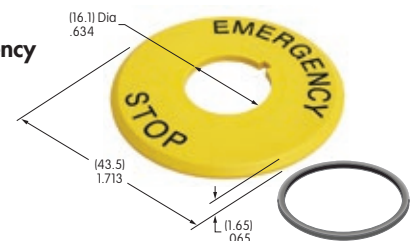

AT220 Protective Guard

One o-ring is provided with each protective guard

Materials & Colors:

Guard: Glass fiber reinforced polyamide

O-ring: Chloroprene rubber

Guard: Yellow

O-ring: Black

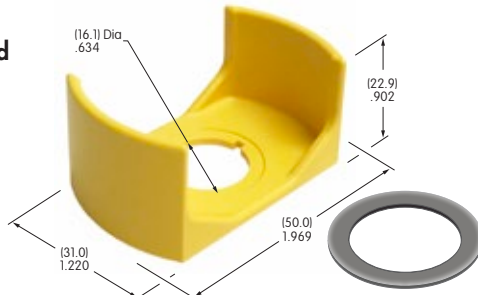

AT119 Socket Wrench

Material:

Brass with nickel plating

Use to tighten switch nut in installation

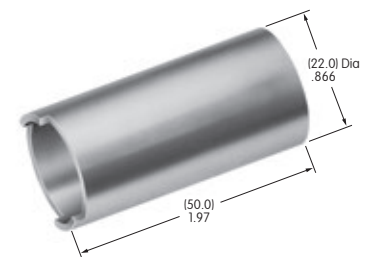

FF0116BBCEEAO1-WL

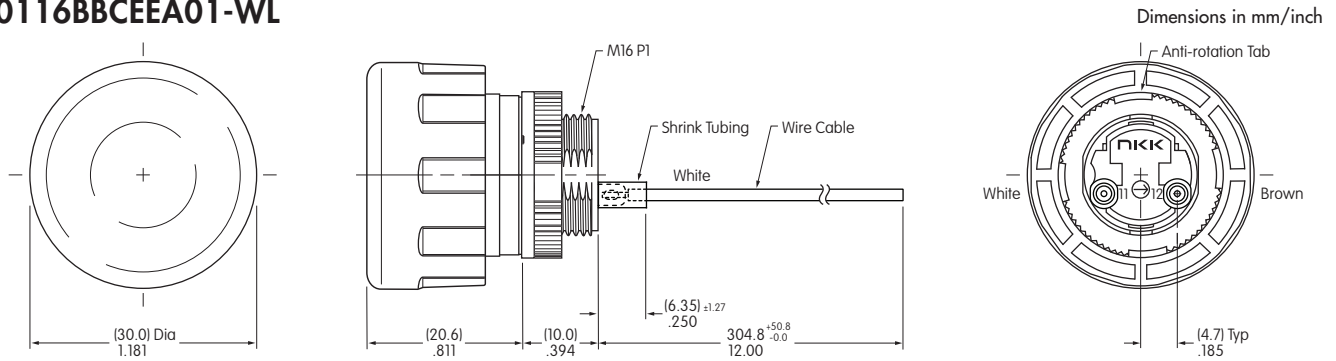

SINGLE POLE SOLDER LUG

Base Switch	Pole & Throw	Plunger Position		Connected Terminals		Throw & Switch Schematics
		Normal	Down	Normal	Down	
						Note: Terminal numbers are on the switch.
FF0116BBCEEAO1	SPST	ON	OFF	11-12	OPEN	SPST NC

PANEL CUTOUT

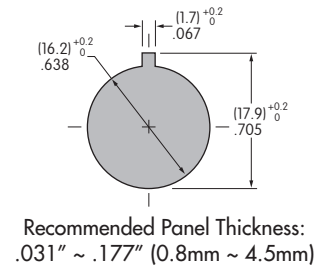

WIRING

Number of Wires	Terminal 11	Terminal 12
2	White	Brown

WIRE SPECIFICATIONS

UL1007/UL1569 PVC	Temperature: +80°C and +105°C (+176°F and +221°F)
Voltage: 300V	
22 AWG Stranded	Stripped Wire Ends .142" (3.6mm)

Base Switch Specifications

Electrical Capacity

Resistive Load: 0.5A @ 24V DC

Other Ratings

Rated Insulation Voltage:	36V DC
Impulse Withstand Voltage:	2.5kV
Contact Resistance:	50 milliohms maximum
Insulation Resistance:	100 megohms minimum @ 500V DC
Mechanical Life:	100,000 operations minimum
Electrical Life:	100,000 operations minimum
Operating Force:	Push to lock 10.8N; Pull to reset 8.5N; Turn to reset 0.13N•m
Minimum Direct Operating Force:	15N
Short Circuit Protection:	gG10A
Conditional Short Circuit Current:	1000A
Minimum Positive Opening Travel:	.118" (3.0mm)
Total Travel:	.177" (4.5mm)
Operation Frequency:	10 times per minute
Overvoltage Category:	II

Materials & Finishes

Actuator:	Glass fiber reinforced polyester (PBT)
Housing:	Glass fiber reinforced polyamide
Movable Contacts:	Silver alloy copper with gold plating
Stationary Contacts:	Silver alloy copper with gold plating
Terminals:	Brass with tin plating

Environmental Data

Operating Temperature Range:	-25°C ~ +60°C (-13°F ~ +140°F)
Storage Temperature Range:	-45°C ~ +80°C (-49°F ~ +176°F)
Humidity:	90 ~ 95% humidity for 240 hours @ +40°C (+104°F)
Vibration:	10 ~ 500Hz, amplitude 0.35mm. Acceleration 50m/s ²
Shock:	Durability: 1,000m/s ² ; Malfunction: 150m/s ²
Pollution Degree:	3
Sealing:	Meets IP65 of IEC 60529 Standards at front panel

Installation

Mounting Torque:	785mN•m
Soldering Time & Temperature:	Manual Soldering: 390°C max for 4 seconds max, 2 cycles
RoHS Compliant:	

Standards & Certifications



UL, C-UL (UL508)



EN 60947-5-1, EN 60947-5-5



Emergency Stop Switches



Characteristics

Low profile body and impressively short behind panel depth of only 13.6mm offer advantages to high density panel layouts. Switches are IP65 rated at the front panel per IEC 60529 Standards (dust tight and protected against water jets from any direction). Outstanding safety and reliability factors are benefits of unique sliding latch mechanism that maintains the OFF state of the contacts. Protection against rugged vibration and chattering credited to internal construction featuring superior shock resistant properties.

All models have solder lug terminals and an actuator in 25 or 30mm diameters, with directional arrow legend or blank surface. Resetting methods include both twisting or pull release for enhanced safety.

The FF01 Series has various accessories, including a protective guard and nameplates with *EMERGENCY STOP* legend or blank. The nameplates and switch guard are all interchangeable for both actuator sizes.

Optional Accessories

AT221
Nameplate
without Legend

One o-ring is provided with each nameplate

Materials & Colors:

Nameplate: Glass fiber reinforced polyamide

O-ring: Chloroprene rubber

Nameplate: Yellow

O-ring: Black

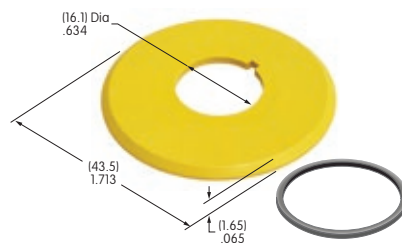
AT222
Nameplate with Emergency
Stop Legend

One o-ring is provided with each nameplate

Materials & Colors:

Nameplate: Glass fiber reinforced polyamide

O-ring: Chloroprene rubber

Nameplate: Yellow with black letters

O-ring: Black

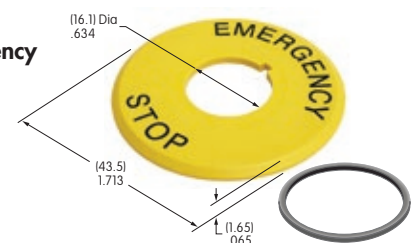
AT220
Protective Guard

One o-ring is provided with each protective guard

Materials & Colors:

Guard: Glass fiber reinforced polyamide

O-ring: Chloroprene rubber

Guard: Yellow

O-ring: Black

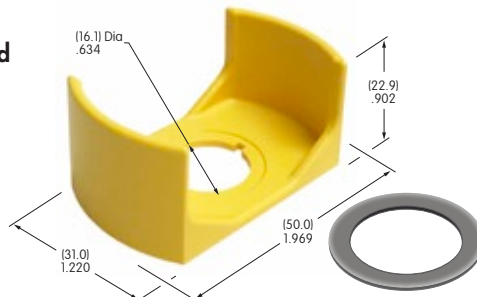
AT119
Socket Wrench
Material:

Brass with nickel plating

Use to tighten switch nut in installation

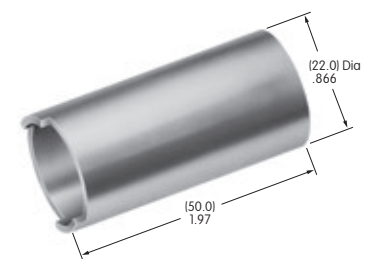

E-Stop Switch with IP65 Rating & Wire Leads

Series FF01

FF0126BACEEA01-WL

Dimensions in mm/inch

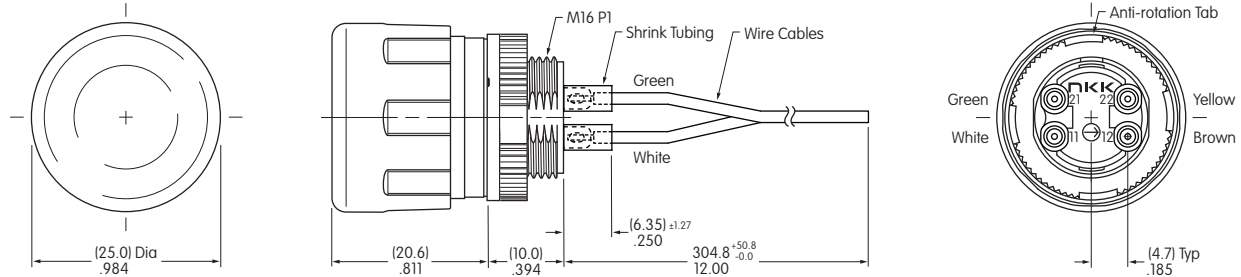

DOUBLE POLE SOLDER LUG

Base Switch	Pole & Throw	Plunger Position		Connected Terminals		Throw & Switch Schematics
		Normal	Down	Normal	Down	
						Note: Terminal numbers are on the switch.
FF0126BACEEA01	DPST	ON	OFF	11-12 21-22	OPEN	DPST NC

PANEL CUTOUT

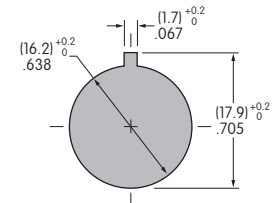

Recommended Panel Thickness:
.031" ~ .177" (0.8mm ~ 4.5mm)

WIRING

Number of Wires	Terminal 11	Terminal 12	Terminal 21	Terminal 22
4	White	Brown	Green	Yellow

WIRE SPECIFICATIONS

UL1007/UL1569 PVC	Temperature: +80°C and +105°C (+176°F and +221°F)
Voltage: 300V	
22 AWG Stranded	Stripped Wire Ends .142" (3.6mm)

Base Switch Specifications

Electrical Capacity

Resistive Load: 0.5A @ 24V DC

Other Ratings

Rated Insulation Voltage: 36V DC
Impulse Withstand Voltage: 2.5kV
Contact Resistance: 50 milliohms maximum
Insulation Resistance: 100 megohms minimum @ 500V DC
Mechanical Life: 100,000 operations minimum
Electrical Life: 100,000 operations minimum
Operating Force: Push to lock 10.8N; Pull to reset 8.5N; Turn to reset 0.13N·m
Minimum Direct Operating Force: 15N
Short Circuit Protection: gG10A
Conditional Short Circuit Current: 1000A
Minimum Positive Opening Travel: .118" (3.0mm)
Total Travel: .177" (4.5mm)
Operation Frequency: 10 times per minute
Overvoltage Category: II

Materials & Finishes

Actuator: Glass fiber reinforced polyester (PBT)
Housing: Glass fiber reinforced polyamide
Movable Contacts: Silver alloy copper with gold plating
Stationary Contacts: Silver alloy copper with gold plating
Terminals: Brass with tin plating

Environmental Data

Operating Temperature Range: -25°C ~ +60°C (-13°F ~ +140°F)
Storage Temperature Range: -45°C ~ +80°C (-49°F ~ +176°F)
Humidity: 90 ~ 95% humidity for 240 hours @ +40°C (+104°F)
Vibration: 10 ~ 500Hz, amplitude 0.35mm. Acceleration 50m/s²
Shock: Durability: 1,000m/s²; Malfunction: 150m/s²
Pollution Degree: 3
Sealing: Meets IP65 of IEC 60529 Standards at front panel

Installation

Mounting Torque: 785mN·m
Soldering Time & Temperature: Manual Soldering: 390°C max for 4 seconds max, 2 cycles
RoHS Compliant:

Standards & Certifications



UL, C-UL (UL508)



EN 60947-5-1, EN 60947-5-5



Emergency Stop Switches



Characteristics

Low profile body and impressively short behind panel depth of only 13.6mm offer advantages to high density panel layouts. Switches are IP65 rated at the front panel per IEC 60529 Standards (dust tight and protected against water jets from any direction). Outstanding safety and reliability factors are benefits of unique sliding latch mechanism that maintains the OFF state of the contacts. Protection against rugged vibration and chattering credited to internal construction featuring superior shock resistant properties.

All models have solder lug terminals and an actuator in 25 or 30mm diameters, with directional arrow legend or blank surface. Resetting methods include both twisting or pull release for enhanced safety.

The FF01 Series has various accessories, including a protective guard and nameplates with *EMERGENCY STOP* legend or blank. The nameplates and switch guard are all interchangeable for both actuator sizes.

Optional Accessories

AT221 Nameplate without Legend

One o-ring is provided with each nameplate

Materials & Colors:

Nameplate: Glass fiber reinforced polyamide

O-ring: Chloroprene rubber

Nameplate: Yellow

O-ring: Black

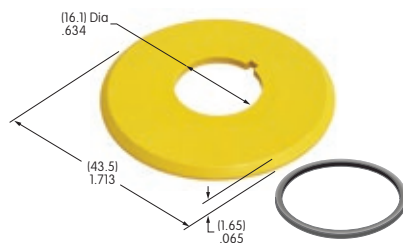

AT222 Nameplate with Emergency Stop Legend

One o-ring is provided with each nameplate

Materials & Colors:

Nameplate: Glass fiber reinforced polyamide

O-ring: Chloroprene rubber

Nameplate: Yellow with black letters

O-ring: Black

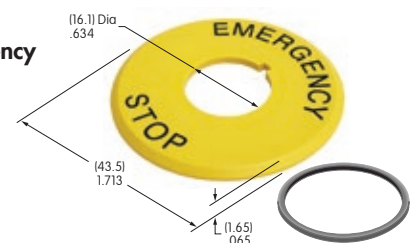

AT220 Protective Guard

One o-ring is provided with each protective guard

Materials & Colors:

Guard: Glass fiber reinforced polyamide

O-ring: Chloroprene rubber

Guard: Yellow

O-ring: Black

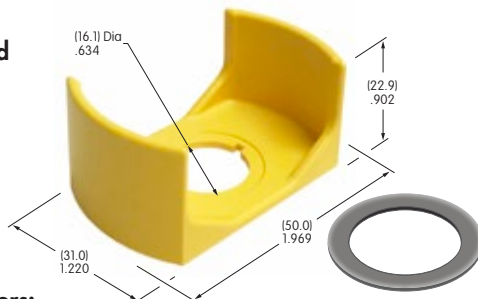

AT119 Socket Wrench

Material:

Brass with nickel plating

Use to tighten switch nut in installation

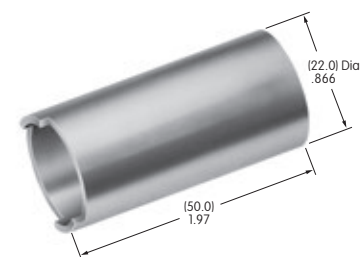

FF0116BACAEA01-WL

Dimensions in mm/inch

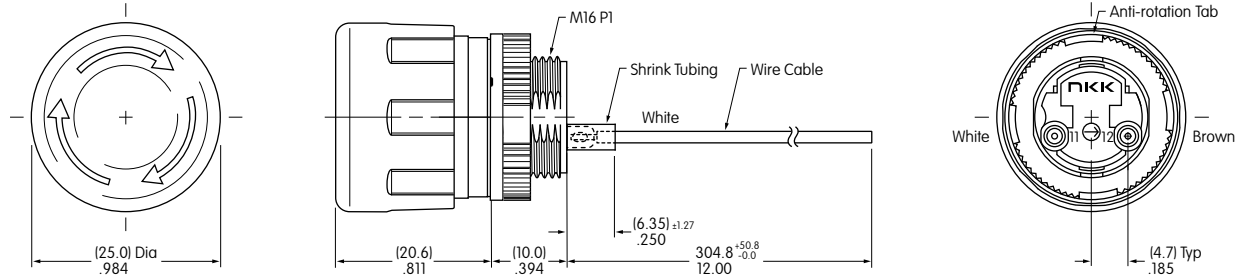

SINGLE POLE SOLDER LUG

Base Switch	Pole & Throw	Plunger Position		Connected Terminals		Throw & Switch Schematics
		Normal	Down	Normal	Down	
						Note: Terminal numbers are on the switch.
FF0116BACAEA01	SPST	ON	OFF	11-12	OPEN	SPST NC

PANEL CUTOUT

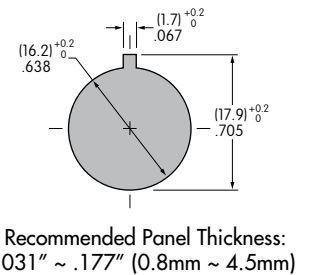

WIRING

Number of Wires	Terminal 11	Terminal 12
2	White	Brown

WIRE SPECIFICATIONS

UL1007/UL1569 PVC	Temperature: +80°C and +105°C (+176°F and +221°F)
Voltage: 300V	
22 AWG Stranded	Stripped Wire Ends .142" (3.6mm)

Base Switch Specifications

Electrical Capacity

Resistive Load: 0.5A @ 24V DC

Other Ratings

Rated Insulation Voltage:	36V DC
Impulse Withstand Voltage:	2.5kV
Contact Resistance:	50 milliohms maximum
Insulation Resistance:	100 megohms minimum @ 500V DC
Mechanical Life:	100,000 operations minimum
Electrical Life:	100,000 operations minimum
Operating Force:	Push to lock 10.8N; Pull to reset 8.5N; Turn to reset 0.13N·m
Minimum Direct Operating Force:	15N
Short Circuit Protection:	gG10A
Conditional Short Circuit Current:	1000A
Minimum Positive Opening Travel:	.118" (3.0mm)
Total Travel:	.177" (4.5mm)
Operation Frequency:	10 times per minute
Overvoltage Category:	II

Materials & Finishes

Actuator:	Glass fiber reinforced polyester (PBT)
Housing:	Glass fiber reinforced polyamide
Movable Contacts:	Silver alloy copper with gold plating
Stationary Contacts:	Silver alloy copper with gold plating
Terminals:	Brass with tin plating

Environmental Data

Operating Temperature Range:	-25°C ~ +60°C (-13°F ~ +140°F)
Storage Temperature Range:	-45°C ~ +80°C (-49°F ~ +176°F)
Humidity:	90 ~ 95% humidity for 240 hours @ +40°C (+104°F)
Vibration:	10 ~ 500Hz, amplitude 0.35mm. Acceleration 50m/s²
Shock:	Durability: 1,000m/s²; Malfunction: 150m/s²
Pollution Degree:	3
Sealing:	Meets IP65 of IEC 60529 Standards at front panel

Installation

Mounting Torque:	785mN·m
Soldering Time & Temperature:	Manual Soldering: 390°C max for 4 seconds max, 2 cycles
RoHS Compliant:	

Standards & Certifications



UL, C-UL (UL508)



EN 60947-5-1, EN 60947-5-5



Emergency Stop Switches



Characteristics

Low profile body and impressively short behind panel depth of only 13.6mm offer advantages to high density panel layouts. Switches are IP65 rated at the front panel per IEC 60529 Standards (dust tight and protected against water jets from any direction). Outstanding safety and reliability factors are benefits of unique sliding latch mechanism that maintains the OFF state of the contacts. Protection against rugged vibration and chattering credited to internal construction featuring superior shock resistant properties.

All models have solder lug terminals and an actuator in 25 or 30mm diameters, with directional arrow legend or blank surface. Resetting methods include both twisting or pull release for enhanced safety.

The FF01 Series has various accessories, including a protective guard and nameplates with *EMERGENCY STOP* legend or blank. The nameplates and switch guard are all interchangeable for both actuator sizes.

Optional Accessories

AT221 Nameplate without Legend

One o-ring is provided with each nameplate

Materials & Colors:

Nameplate: Glass fiber reinforced polyamide

O-ring: Chloroprene rubber

Nameplate: Yellow

O-ring: Black

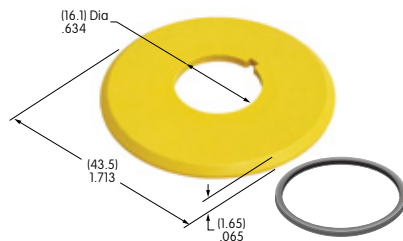

AT222 Nameplate with Emergency Stop Legend

One o-ring is provided with each nameplate

Materials & Colors:

Nameplate: Glass fiber reinforced polyamide

O-ring: Chloroprene rubber

Nameplate: Yellow with black letters

O-ring: Black

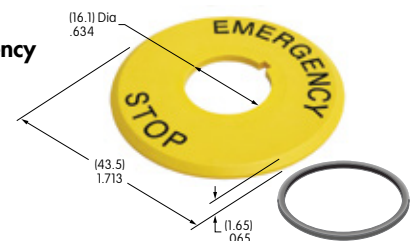

AT220 Protective Guard

One o-ring is provided with each protective guard

Materials & Colors:

Guard: Glass fiber reinforced polyamide

O-ring: Chloroprene rubber

Guard: Yellow

O-ring: Black

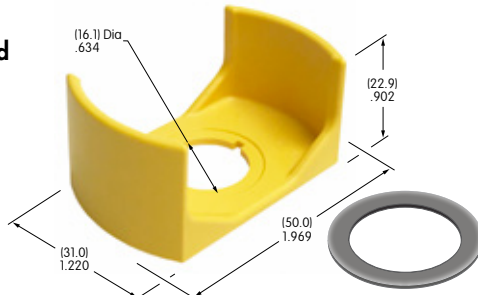

AT119 Socket Wrench

Material:

Brass with nickel plating

Use to tighten switch nut in installation

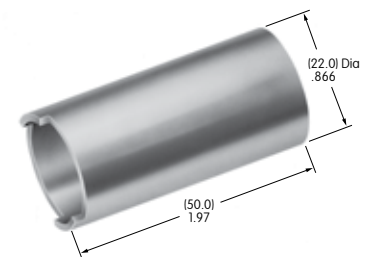

FF0126BACAEA01-WL

Dimensions in mm/inch

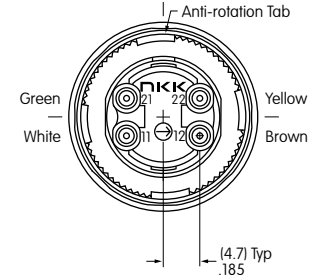
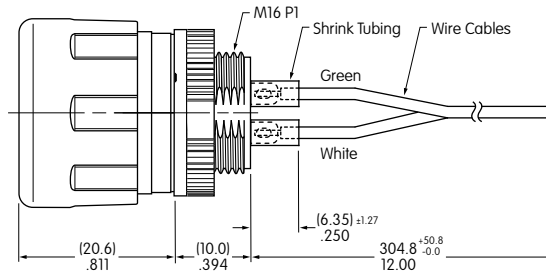
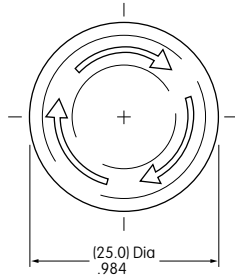

DOUBLE POLE SOLDER LUG

PANEL CUTOUT

Base Switch	Pole & Throw	Plunger Position		Connected Terminals		Throw & Switch Schematics
		Normal	Down	Normal	Down	
						Note: Terminal numbers are on the switch.
FF0126BACAEA01	DPST	ON	OFF	11-12 21-22	OPEN	DPST NC

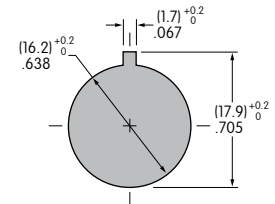

Recommended Panel Thickness:
.031" ~ .177" (0.8mm ~ 4.5mm)

WIRING

Number of Wires	Terminal 11	Terminal 12	Terminal 21	Terminal 22
4	White	Brown	Green	Yellow

WIRE SPECIFICATIONS

UL1007/UL1569 PVC	Temperature: +80°C and +105°C (+176°F and +221°F)
Voltage: 300V	
22 AWG Stranded	Stripped Wire Ends .142" (3.6mm)

Base Switch Specifications

Electrical Capacity

Resistive Load: 0.5A @ 24V DC

Other Ratings

Rated Insulation Voltage: 36V DC

Impulse Withstand Voltage: 2.5kV

Contact Resistance: 50 milliohms maximum

Insulation Resistance: 100 megohms minimum @ 500V DC

Mechanical Life: 100,000 operations minimum

Electrical Life: 100,000 operations minimum

Operating Force: Push to lock 10.8N; Pull to reset 8.5N;
Turn to reset 0.13N·m

Minimum Direct Operating Force: 15N

Short Circuit Protection: gG10A

Conditional Short Circuit Current: 1000A

Minimum Positive Opening Travel: .118" (3.0mm)

Total Travel: .177" (4.5mm)

Operation Frequency: 10 times per minute

Overvoltage Category: II

Materials & Finishes

Actuator: Glass fiber reinforced polyester (PBT)

Housing: Glass fiber reinforced polyamide

Movable Contacts: Silver alloy copper with gold plating

Stationary Contacts: Silver alloy copper with gold plating

Terminals: Brass with tin plating

Environmental Data

Operating Temperature Range: -25°C ~ +60°C (-13°F ~ +140°F)

Storage Temperature Range: -45°C ~ +80°C (-49°F ~ +176°F)

Humidity: 90 ~ 95% humidity for 240 hours
@ +40°C (+104°F)

Vibration: 10 ~ 500Hz, amplitude 0.35mm.
Acceleration 50m/s²

Shock: Durability: 1,000m/s²;
Malfunction: 150m/s²

Pollution Degree: 3

Sealing: Meets IP65 of IEC 60529
Standards at front panel

Installation

Mounting Torque: 785mN·m

Soldering Time & Temperature: Manual Soldering: 390°C max
for 4 seconds max, 2 cycles

RoHS Compliant:

Standards & Certifications



UL, C-UL (UL508)



EN 60947-5-1, EN 60947-5-5



Emergency Stop Switches



Characteristics

Low profile body and impressively short behind panel depth of only 13.6mm offer advantages to high density panel layouts. Switches are IP65 rated at the front panel per IEC 60529 Standards (dust tight and protected against water jets from any direction). Outstanding safety and reliability factors are benefits of unique sliding latch mechanism that maintains the OFF state of the contacts. Protection against rugged vibration and chattering credited to internal construction featuring superior shock resistant properties.

All models have solder lug terminals and an actuator in 25 or 30mm diameters, with directional arrow legend or blank surface. Resetting methods include both twisting or pull release for enhanced safety.

The FF01 Series has various accessories, including a protective guard and nameplates with *EMERGENCY STOP* legend or blank. The nameplates and switch guard are all interchangeable for both actuator sizes.

Optional Accessories

AT221 Nameplate without Legend

One o-ring is provided with each nameplate

Materials & Colors:

Nameplate: Glass fiber reinforced polyamide
O-ring: Chloroprene rubber
Nameplate: Yellow
O-ring: Black

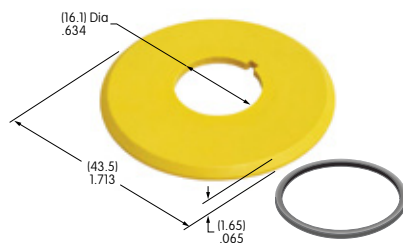

AT222 Nameplate with Emergency Stop Legend

One o-ring is provided with each nameplate

Materials & Colors:

Nameplate: Glass fiber reinforced polyamide
O-ring: Chloroprene rubber
Nameplate: Yellow with black letters
O-ring: Black

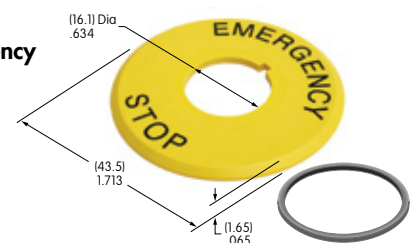

AT220 Protective Guard

One o-ring is provided with each protective guard

Materials & Colors:

Guard: Glass fiber reinforced polyamide
O-ring: Chloroprene rubber
Guard: Yellow
O-ring: Black

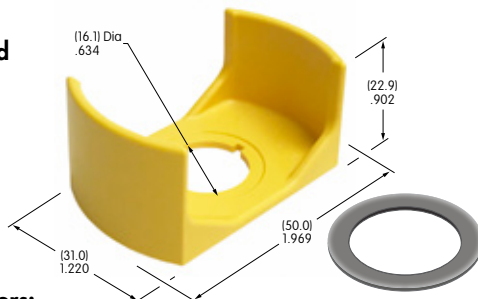

AT119 Socket Wrench

Material:

Brass with nickel plating

Use to tighten switch nut in installation

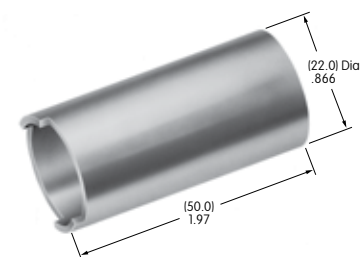

FF0126BBCAEA01-WL

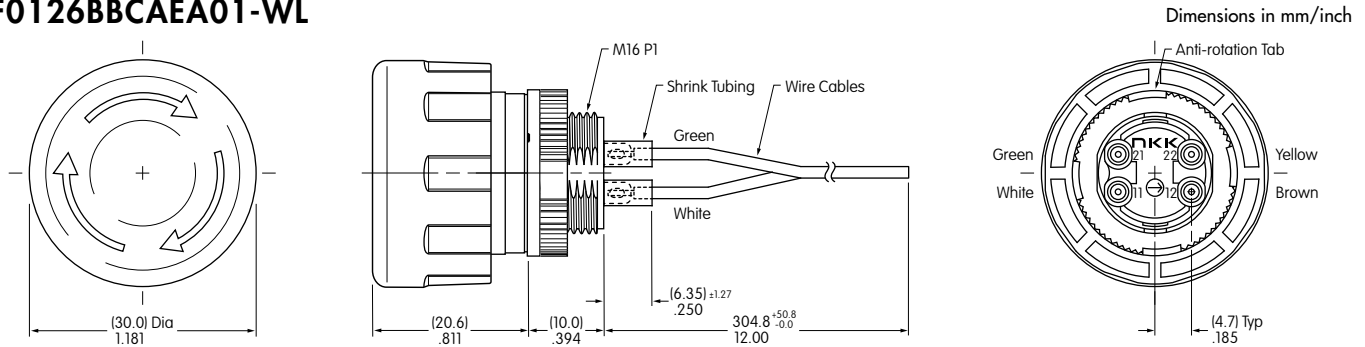

DOUBLE POLE SOLDER LUG

Base Switch	Pole & Throw	Plunger Position		Connected Terminals		Throw & Switch Schematics
		Normal	Down	Normal	Down	
FF0126BBCAEA01	DPST	ON	OFF	11-12 21-22	OPEN	DPST NC Note: Terminal numbers are on the switch.

PANEL CUTOUT

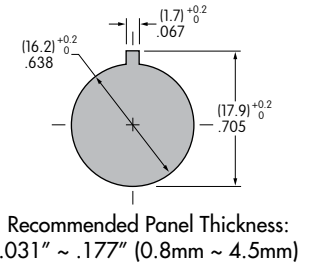

WIRING

Number of Wires	Terminal 11	Terminal 12	Terminal 21	Terminal 22
4	White	Brown	Green	Yellow

WIRE SPECIFICATIONS

UL1007/UL1569 PVC	Temperature: +80°C and +105°C (+176°F and +221°F)
Voltage: 300V	
22 AWG Stranded	Stripped Wire Ends .142" (3.6mm)

Base Switch Specifications

Electrical Capacity

Resistive Load: 0.5A @ 24V DC

Other Ratings

Rated Insulation Voltage: 36V DC
Impulse Withstand Voltage: 2.5kV
Contact Resistance: 50 milliohms maximum
Insulation Resistance: 100 megohms minimum @ 500V DC
Mechanical Life: 100,000 operations minimum
Electrical Life: 100,000 operations minimum
Operating Force: Push to lock 10.8N; Pull to reset 8.5N; Turn to reset 0.13N·m
Minimum Direct Operating Force: 15N
Short Circuit Protection: gG10A
Conditional Short Circuit Current: 1000A
Minimum Positive Opening Travel: .118" (3.0mm)
Total Travel: .177" (4.5mm)
Operation Frequency: 10 times per minute
Overvoltage Category: II

Materials & Finishes

Actuator: Glass fiber reinforced polyester (PBT)
Housing: Glass fiber reinforced polyamide
Movable Contacts: Silver alloy copper with gold plating
Stationary Contacts: Silver alloy copper with gold plating
Terminals: Brass with tin plating

Environmental Data

Operating Temperature Range: -25°C ~ +60°C (-13°F ~ +140°F)
Storage Temperature Range: -45°C ~ +80°C (-49°F ~ +176°F)
Humidity: 90 ~ 95% humidity for 240 hours @ +40°C (+104°F)
Vibration: 10 ~ 500Hz, amplitude 0.35mm. Acceleration 50m/s²
Shock: Durability: 1,000m/s²; Malfunction: 150m/s²
Pollution Degree: 3
Sealing: Meets IP65 of IEC 60529 Standards at front panel

Installation

Mounting Torque: 785mN·m
Soldering Time & Temperature: Manual Soldering: 390°C max for 4 seconds max, 2 cycles
RoHS Compliant:

Standards & Certifications



UL, C-UL (UL508)



EN 60947-5-1, EN 60947-5-5



Emergency Stop Switches



Characteristics

Low profile body and impressively short behind panel depth of only 13.6mm offer advantages to high density panel layouts. Switches are IP65 rated at the front panel per IEC 60529 Standards (dust tight and protected against water jets from any direction). Outstanding safety and reliability factors are benefits of unique sliding latch mechanism that maintains the OFF state of the contacts. Protection against rugged vibration and chattering credited to internal construction featuring superior shock resistant properties.

All models have solder lug terminals and an actuator in 25 or 30mm diameters, with directional arrow legend or blank surface. Resetting methods include both twisting or pull release for enhanced safety.

The FF01 Series has various accessories, including a protective guard and nameplates with *EMERGENCY STOP* legend or blank. The nameplates and switch guard are all interchangeable for both actuator sizes.

Optional Accessories

AT221 Nameplate without Legend

One o-ring is provided with each nameplate

Materials & Colors:

Nameplate: Glass fiber reinforced polyamide
O-ring: Chloroprene rubber
Nameplate: Yellow
O-ring: Black

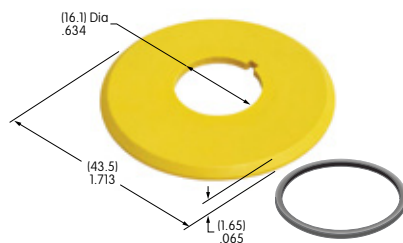

AT222 Nameplate with Emergency Stop Legend

One o-ring is provided with each nameplate

Materials & Colors:

Nameplate: Glass fiber reinforced polyamide
O-ring: Chloroprene rubber
Nameplate: Yellow with black letters
O-ring: Black

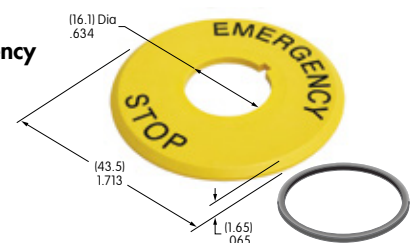

AT220 Protective Guard

One o-ring is provided with each protective guard

Materials & Colors:

Guard: Glass fiber reinforced polyamide
O-ring: Chloroprene rubber
Guard: Yellow
O-ring: Black

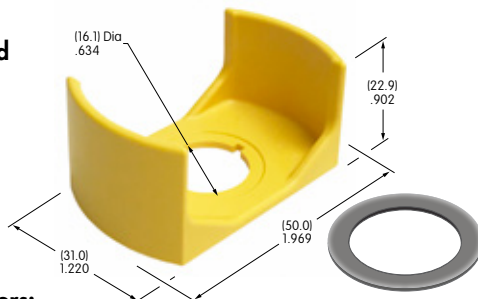

AT119 Socket Wrench

Material:

Brass with nickel plating

Use to tighten switch nut in installation

