

Accessories & Hardware

AT532T (M-metric H-inch)
Threaded Through Dress Nut
Brass with nickel plating
Series: EB M MB20 MB24 P

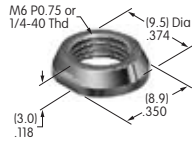

AT533T (M-metric H-inch)
Threaded Through Dress Nut
Brass with nickel plating
Series: EB M MB20 MB24 P

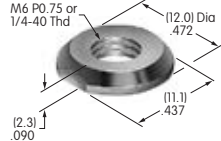

AT535
Rubber Ring for
MR Panel Seal
Nitrile butadiene rubber
Series: MRB MRK



AT536
Hex Nut
Brass with nickel plating
Series: FB

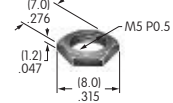

AT537
O-ring
Nitrile butadiene rubber
Series: S

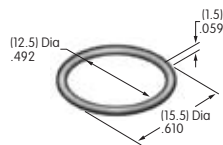

AT541
O-ring for Panel Seal
with AT4115
Nitrile butadiene rubber
Series: YB

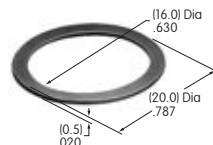

AT542
Coupler for
LCD 36 x 24 Pushbutton
PBT
Series: SmartSwitch

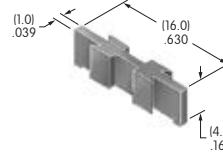

AT543
Support Bracket
Steel with tin plating
Series: MRK

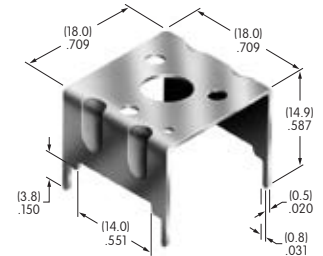

AT545
Locking Ring
Steel with zinc/chromate
Series: MRA MRB MRK

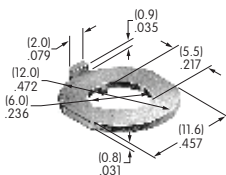

AT546
Mounting Bracket
for Block Mounting
Phosphor bronze with tin plating
Series: GB2

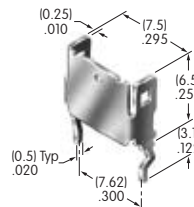

AT547
Mounter for AT4140
Polyamide
Color: A
Series: JB

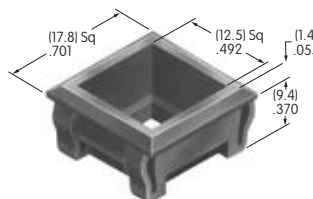

AT548
Panel Mount Housing for
LCD 36 x 24 Pushbutton
(not for Compact SmartSwitch)
Polyamide
Color: A
Series: SmartSwitch

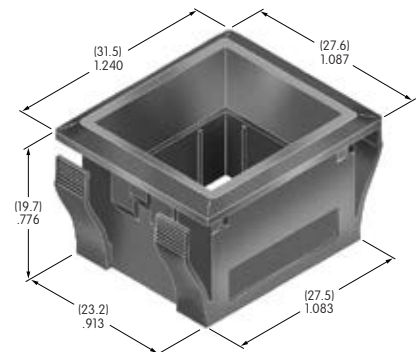

Color Codes: A Black B White C Red D Amber E Yellow F Green G Blue H Gray J Clear